

Why this machine would work for you

Compatibility: The PieceGiver can be easily retrofitted to work seamlessly with your existing PieceMaker saw, saving you time and money.

Increased Productivity: Many linear saws have their output limited by the operator. The PieceGiver ensures uninterrupted operation throughout the day, significantly increasing productivity.

Increased Output: Experience a remarkable improvement in the output of your saw, enabling you to complete more work in less time.

Single-Person Operation: Efficient operation with just one person, making production more cost-effective.

Minimised Risk: Manual handling is significantly reduced, resulting in fewer injuries and accidents.

Production Reliability: PieceGiver delivers dependable and reliable performance day in and day out.



PieceGiver

Auto Timber Feed System

To find out more or book a demonstration, contact your Multinail Business Development Manager or National Machinery Sales Manager

Stuart McBean
Business Development Manager (QLD, WA, NT & SA)
0408 651 576
Stuart.McBean@multinail.com

Danny Fleetwood
Business Development Manager (ACT & NSW)
0403 269 534
Danny.Fleetwood@multinail.com

Kevin Labrooy
Business Development Manager (VIC & TAS)
0408 226 146
Kevin.Labrooy@multinail.com

Warwick Porter
National Machinery Sales Manager
0419 516 918
Warwick.Porter@multinail.com

Multinail Australia Pty. Ltd.
155 Burnside Road
Stapylton, QLD 4207

Phone: 07 3297 3250
Email: enquiry@multinail.com
www.multinail.com.au



PieceGiver



USED FOR

Optimise your cutting operations. Increase machine runtime and reduce repetitive injury by introducing the PieceGiver to your workflow.

FEATURES

- All packs are stored and presented at ground level, eliminating OH&S risks associated with working at heights
- Picks two pieces during the cycle
- Market leading timber pickup mechanism. It's very rare for this machine to drop a piece of timber. This adds to the speed and functionality of the machine
- Equipped with eight suction heads
- Safety light curtains
- Compatible with both European and Australian timber pack sizes
- Retrofittable to any PieceMaker saw
- Designed, built, and supported locally

OPTIONS

- Left or right hand feed
- Load the timber from the end or side of the machine. This allows you to customise the machine to suit your floor plan and material flow
- The length of the system and the total number of packs to be supported are flexible
- Timber pack storage 3350mm, 5975mm, 8600mm or 11225mm
- Extra pack trollies can be purchased separately
- Bow flipping & double stacking devices

SPECIFICATIONS (2 module)

241A900

Overall length, width, height	10043mm x 8891mm x 3100mm
Min/Max timber dimension	70x35mm/300x45mm
Min/Max feed lengths	2400mm/6000mm
Machine mass	6700kg
Electrical requirement	415V, 63amp, 3 phase neutral & earth
Air requirement	40L/min avg. 500L/min Peak @ 100psi
Maximum travel velocity for gantry	3m/s

Top view

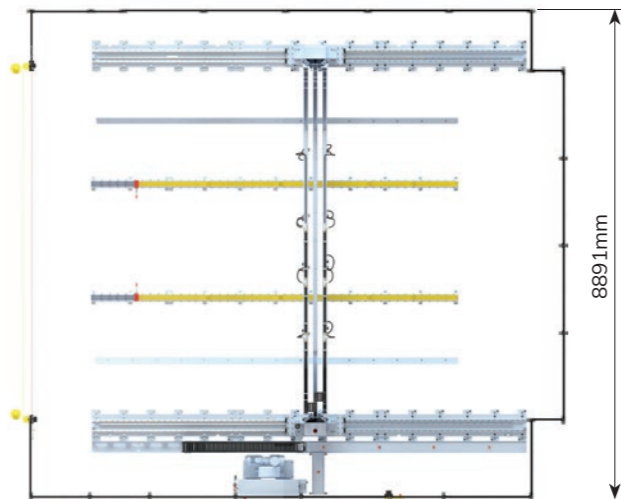

Front view

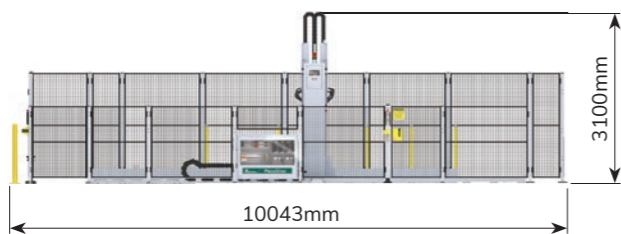

PieceGiver

Auto Timber Feed System

PieceGiver is a fully automatic timber feeding system that will significantly increase the productivity of your PieceMaker without adding to the workforce. The rapid picking cycle from any number of packs delivers maximum production speed with the versatility to process multiple timber sizes up to 300mm x 45mm x 6m LVL.



Timber pack storage



Safety light curtains



10-second picking cycle time from first pack to deck



Controller



Bow flipping & double stacking devices



Retrofittable to any PieceMaker saw



Scan for more information