

Multinail High Load Easy Fix Girder Bracket

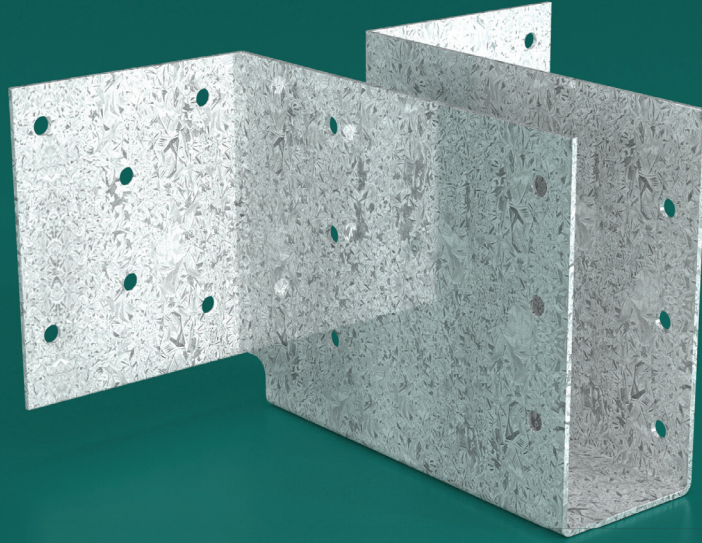

Steel girder brackets for easy fixing of timber roof trusses or rafters to the girder trusses or timber beams.

Benefits of High Load Easy Fix Girder Bracket

These pre-punched and formed galvanised steel girder brackets are:

- Ideal for supporting timber roof trusses or rafters in high wind areas
- Made in Australia

Installation

1. Mark the location of High Load Easy Fix Girder Bracket on the bottom chord of girder truss. Ensure a minimum bottom chord depth of 120mm is achieved.
2. Position High Load Easy Fix Girder Bracket against bottom chord of girder truss. Apply 12 x Black Tip #14 screws (6 per side).
 - For single girder truss (35mm & 45mm) – use 12 x 30mm Black Tip screws.
 - For double girder truss (2/35mm) – use 12 x 65mm Black Tip screws.
 - For double girder truss (2/45mm) & triple girder truss (3/35mm) – use 12 x 65mm Black Tip #14 screws.
3. Install supported truss into bracket and ensure the truss is hard up against girder truss. Apply 12 x Black Tip #14 screws (6 per side).
 - Single supported truss (35mm & 45mm) – use 12 x 30mm Black Tip #14 screws.

Note:

- **Do not** overtighten the screws. **Do not** use power drills which providing excessive torque. It may damage screws or bracket and potentially split the timber chord.
- Multinail recommends using powered screwdrivers to install screws. Screws must be fixed at 90° angle to High Load Easy Fix Girder Bracket in one action till achieving full thread embedment.
- Predrill the holes for all screws where hardwood bottom chord is designed for girder truss.
- All screws must be installed properly and secured tightly before roofing material is loaded on roof trusses to avoid rotation.
- Multinail only certifies High Load Easy Fix Girder Bracket with Black Tip #14 screws being applied.

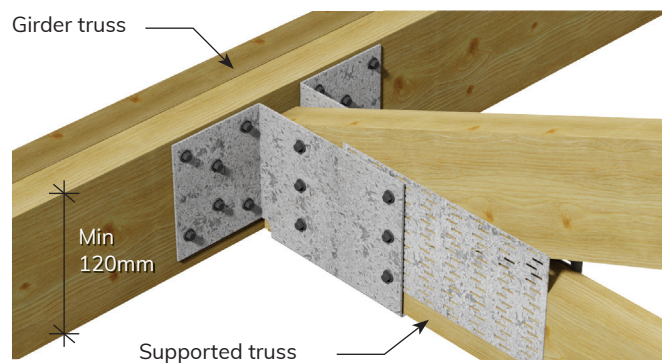

Figure 1: High Load Easy Fix Girder Bracket

Limit State Design Loads

Timber Joint Group	Black Tip #12 Screws (kN)		
	Dead Load	Dead Load + Live Load	Dead Load + Wind Load
JD3	14.8	20.0	29.1
JD4	10.4	14.0	20.7
JD5	7.3	10.0	14.8

Note:

Limit state design capacities are obtained from laboratory testing and derived from AS1720.1 for houses where failure is unlikely to affect an area greater than 25m². For primary elements in structures other than houses or elements in a house for which failure would be greater than 25m² these capacities must be multiplied by 0.94. For primary joints in essential services or post disaster buildings multiply by 0.88.

Technical Specifications

Steel Z275, 1.5mm Thickness

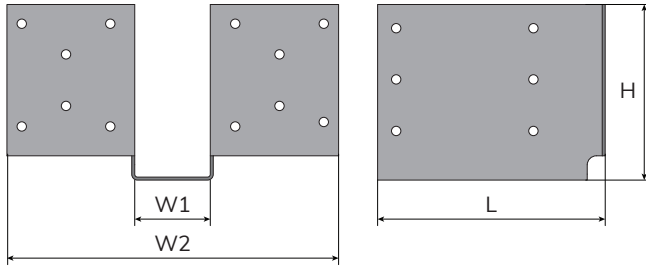

Product Code	W1 mm	W2 mm	L mm	H mm
TA227	40	216	155	120
TA228	50	226	155	115

Description and Packing

Product Code	Description	Carton Qty	Pallet Qty	Carton kg.
TA227	40mm	12	48	12.1
TA228	50mm	12	48	12.1

Fixings



Note: Must order appropriate quantity of Black Tip screws

TA233	30mm Black Tip screw
TA235	65mm Black Tip screw
TA237	100mm Black Tip screw



Multinail Australia Pty. Ltd.
155 Burnside Road, Stapylton
QLD 4207, Australia
Phone: +61 (0)7 3297 3250
Email: enquiry@multinail.com
www.multinail.com.au